

PLAN

HORIZ: 1" = 500'

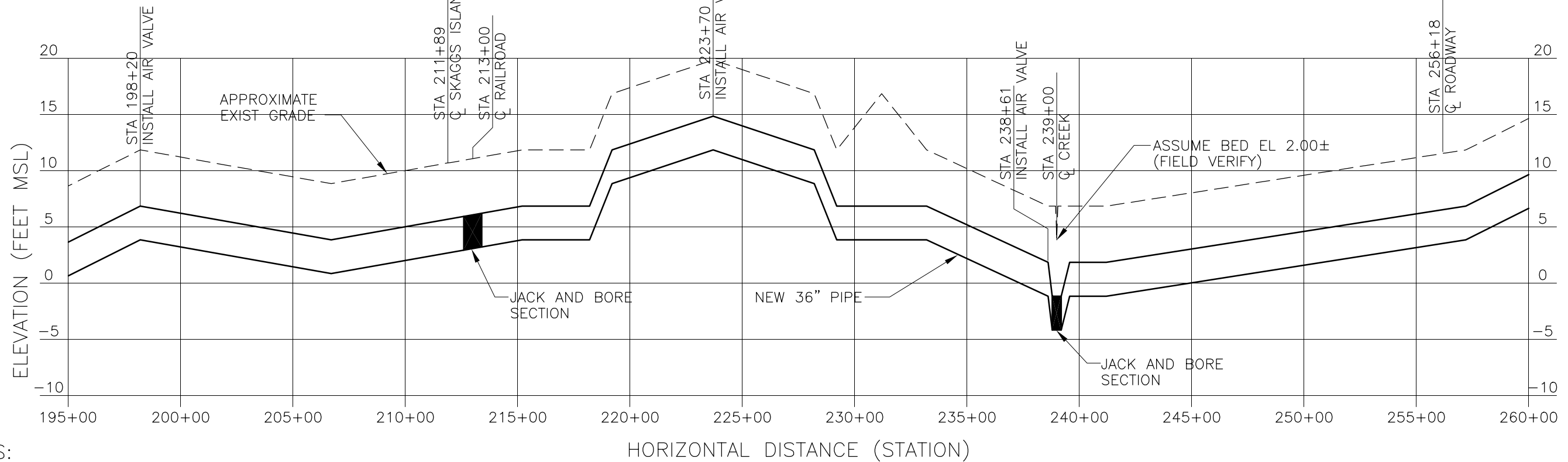

PROFILE

HORIZ: 1" = 500'
VERT: 1" = 10'

NOTES:

1. ALL STATIONS ARE APPROXIMATE.
2. SURFACE TOPOGRAPHY FOR NEW PIPELINE OBTAINED FROM USGS QUAD MAPS.
3. SEE DET A/7 FOR TYPICAL TRENCH AND EASEMENT SECTION.

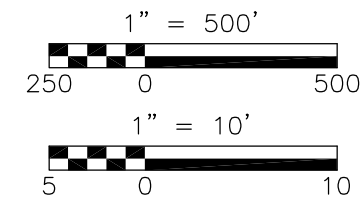

Sonoma County Water Agency	
NAPA-SONOMA SALT MARSH RESTORATION	
DATE: May 2002	SHEET: 4 OF 7