

HORIZ: 1" = 500'

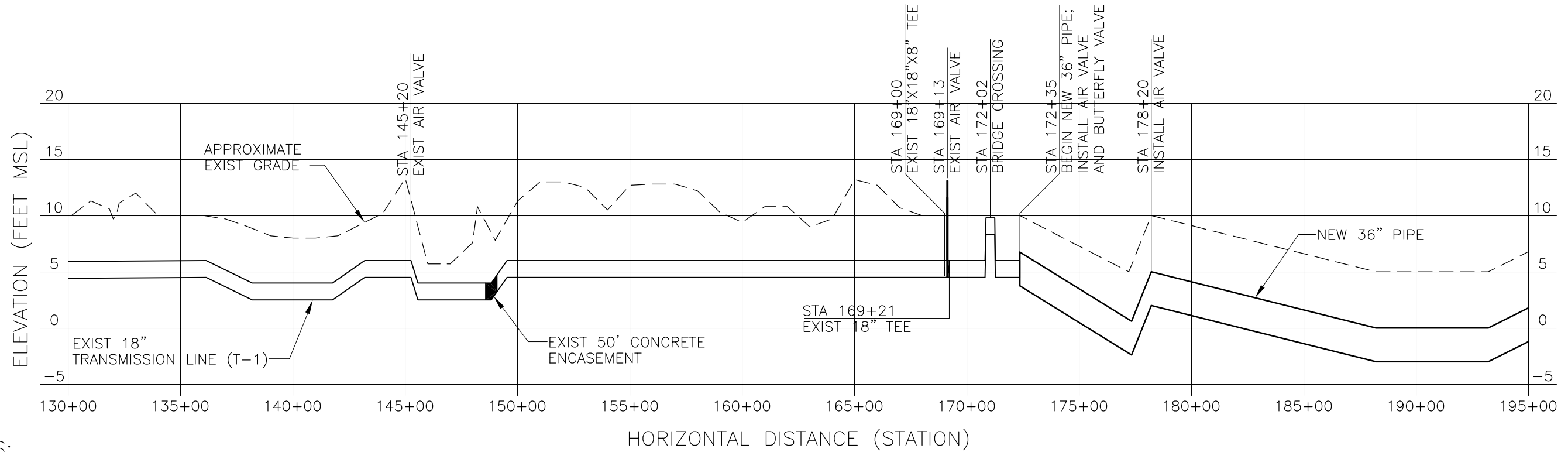

**PROFILE**

HORIZ: 1" = 500'  
VERT: 1" = 10'

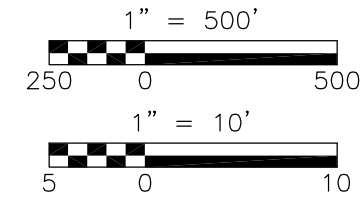

**NOTES:**

1. ALL STATIONS ARE APPROXIMATE.
2. EXISTING PIPELINE FEATURES AND SURFACE TOPOGRAPHY OBTAINED FROM AS-BUILT DRAWINGS.
3. SURFACE TOPOGRAPHY FOR NEW PIPELINE OBTAINED FROM USGS QUAD MAPS.
4. SEE DET A/7 FOR TYPICAL TRENCH AND EASEMENT SECTION.

Sonoma County Water Agency	
<b>NAPA-SONOMA SALT MARSH RESTORATION</b>	
DATE: May 2002	SHEET: 3 OF 7